

### 100-240VAC 2W RECTANGULAR FLAT AND LOUVERED TRIM LED STEP AND PATHWAY LIGHTING

PROJECT

TYPE

CATALOG NUMBER

#### PRODUCT DESCRIPTION

Step and pathway lighting has become a bit brighter with the introduction of GM Lighting's NEW 100-240VAC 2W LED Rectangular Step and Pathway Light. The step light's round flat trim offers a highly visible illuminated detail and the louvered trim directs light onto the horizontal plane directly below it, making your indoor or outdoor steps or pathways visible and safe to access.

#### PRODUCT SPECIFICATIONS

**Construction:** Solid die cast face plate.

**Electrical:** 100-240VAC 2W. 50,000 hour life.

**Power Supply:** Line voltage. No power supply needed.

**Dimming:** Not dimmable.

**Mounting:** Easy to mount. Please check local construction codes.

**Rating:** Rated for indoor or outdoor applications. UL listed for through wiring with junction box.



STLS-FT-BNK



STLS-LT-B

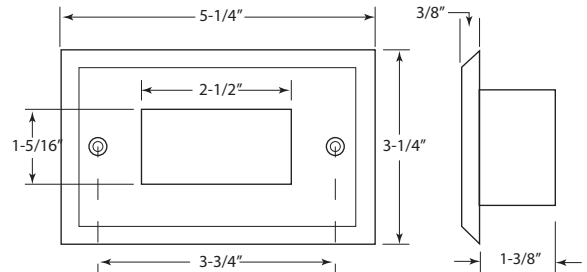

Catalog No.	Description	Wattage	Dimensions	Finish	LED Life
STLS-FT-W	Rectangular Shield	2W	5-1/4"W x 3-1/4"H x 3/8"D	White	50,000 hrs.
STLS-FT-B	Rectangular Shield	2W	5-1/4"W x 3-1/4"H x 3/8"D	Black	50,000 hrs.
STLS-FT-BNK	Rectangular Shield	2W	5-1/4"W x 3-1/4"H x 3/8"D	Brushed Nickel	50,000 hrs.
STLS-FT-DBZ	Rectangular Shield	2W	5-1/4"W x 3-1/4"H x 3/8"D	Dark Bronze	50,000 hrs.
STLS-FT-CP	Rectangular Shield	2W	5-1/4" x 3-1/4" x 3/8"D	Copper	50,000 hrs.
STLS-LT-W	Rectangular Louvered Shield	2W	5-1/4"W x 3-1/4"H x 3/8"D	White	50,000 hrs.
STLS-LT-B	Rectangular Louvered Shield	2W	5-1/4"W x 3-1/4"H x 3/8"D	Black	50,000 hrs.
STLS-LT-BNK	Rectangular Louvered Shield	2W	5-1/4"W x 3-1/4"H x 3/8"D	Brushed Nickel	50,000 hrs.
STLS-LT-DBZ	Rectangular Louvered Shield	2W	5-1/4"W x 3-1/4"H x 3/8"D	Dark Bronze	50,000 hrs.
STLS-LT-CP	Rectangular Louvered Shield	2W	5-1/4"W x 3-1/4"H x 3/8"D	Copper	50,000 hrs.

For a full line of spec sheets and mounting instructions, please see our website at [www.gmlighting.net](http://www.gmlighting.net)